

LAP STYLE JOINT EXHAUST CLAMP



Durable clamping performance for pipes, flexible and mufflers.

DESCRIPTION

It offers a simple, effective way to connect exhaust system components. The pre-formed wideband exhaust clamp with step is designed for fast, easy and accurate installation. There is no need to separate pipes or exhaust members before clamping.

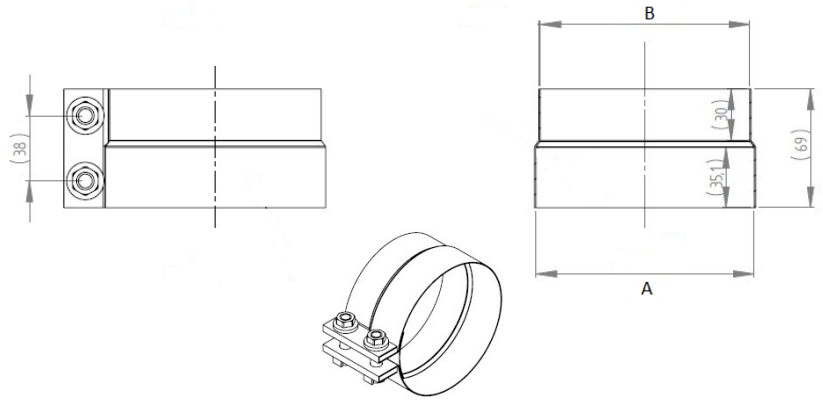

APPLICATION

- Exhaust manifold Pipe
- Exhaust Pipe
- Stepped Pipes

BENEFITS

Exclusive design makes for fast, easy and accurate installation
Causes no damaging distortion to pipe or flex.

Band is designed for maximum stretch providing tight take-up on pipe/pipe or pipe/flex applications

MATERIAL	W1	W4
----------	----	----

KYZ. No.	A Ölçü. Diam.		B Ölçü. Diam.	
	Ø mm	Ø inch.	Ø mm	Ø inch.
KYZ/SK-55	55.0	2 1/8	50.0	2
KYZ/SK-57	57.0	2 1/4	62.0	2 1/2
KYZ/SK-65	65.0	2 1/2	60.0	2 3/8
KYZ/SK-67	67.0	2 2/3	63.5	2 1/2
KYZ/SK-75	75.0	3	70.0	2 3/4
KYZ/SK-81	81.2	3 1/3	76.2	3
KYZ/SK-84	84.0	3 1/3	80.0	3 1/8
KYZ/SK-93	93.6	3 2/3	88.9	3 1/2
KYZ/SK-105	105.0	4 1/5	100.0	3 7/8
KYZ/SK-106	106.6	4 1/5	101.6	4
KYZ/SK-113	113.0	4 1/2	108.0	4 1/4
KYZ/SK-115	115.0	4 1/2	110.0	4 1/3
KYZ/SK-119	119.0	4 3/4	114.3	4 1/2
KYZ/SK-125	125.0	5	120.0	4 3/4
KYZ/SK-132	132.0	5 1/5	127.0	5
KYZ/SK-158	158.0	5 1/5	152.0	6

KARYILDIZ KELEPÇE MET. SAN. TİC. LTD. ŞTİ. TURKEY is certified according to ANAB ISO 9001:2008